

ADJOINS SHEET 13

ADJOINS SHEET 8

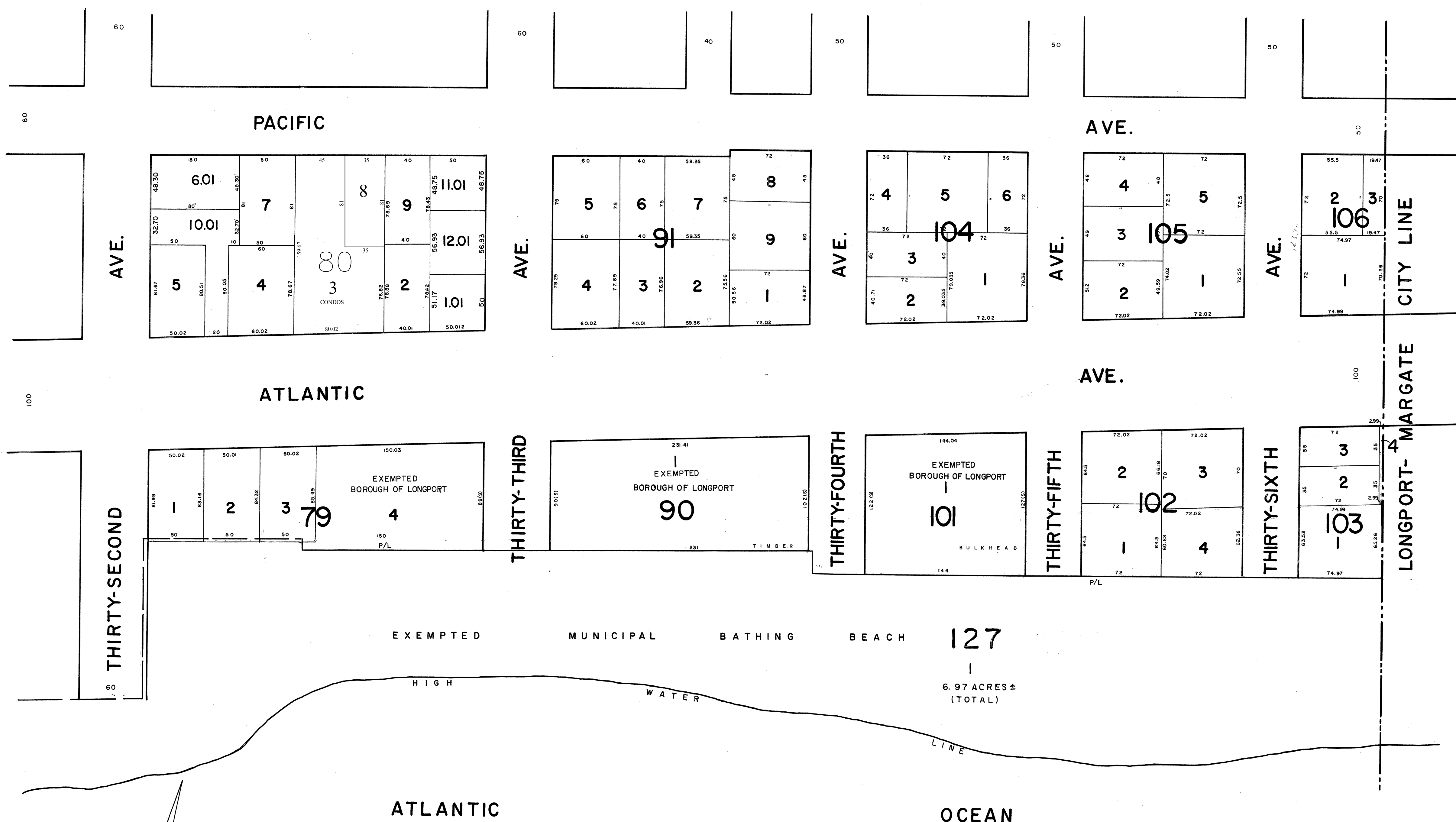

DATE	REVISIONS	BY
12-1-92	GENERAL - PER N.J. DEPT. OF TREASURY	CBA

ELECTRONIC COPY

DANIEL J. PONZIO SR.
 NEW JERSEY LIC. #GS37603
 TO SHOW CONDITIONS AS OF JUNE, 2017

NEW JERSEY DEPARTMENT OF THE TREASURY
 DIVISION OF TAXATION
 PUBLIC UTILITY TAX BUREAU
 APPROVED AS A TAX MAP PURSUANT TO THE
 PROVISIONS OF CHAPTER 175, LAWS OF 1911, ETC.
 FOR THE DIRECTOR, DIVISION OF TAXATION.
 BY *[Signature]* LIC. #5009 STATE SUPERVISOR
 DATE DEC 8 1970 SERIAL No. 498

TAX MAP
 OF THE
BOROUGH OF LONGPORT
ATLANTIC COUNTY, N.J.

SCALE: 1" = 50'
 REV. JAN. 1984

J. THOMAS WOOD, JR., P.E. & L.S. NO. 8139
 GEORGE E. SCHILLING L.S. NO. 16198
 421 GUARANTEE TRUST BLDG.
 ATLANTIC CITY, N.J.