

ADJOINS SHEET 5

ADJOINS SHEET 8

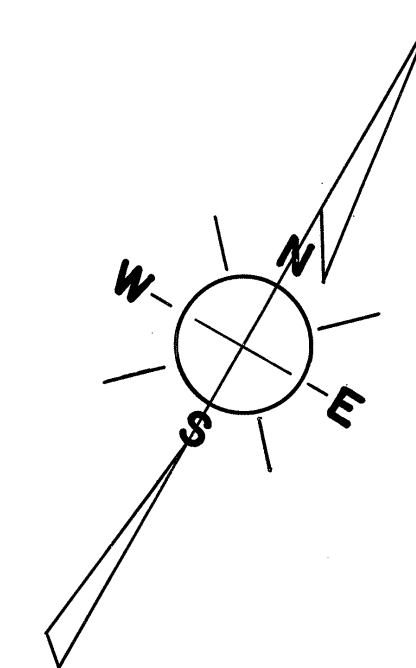
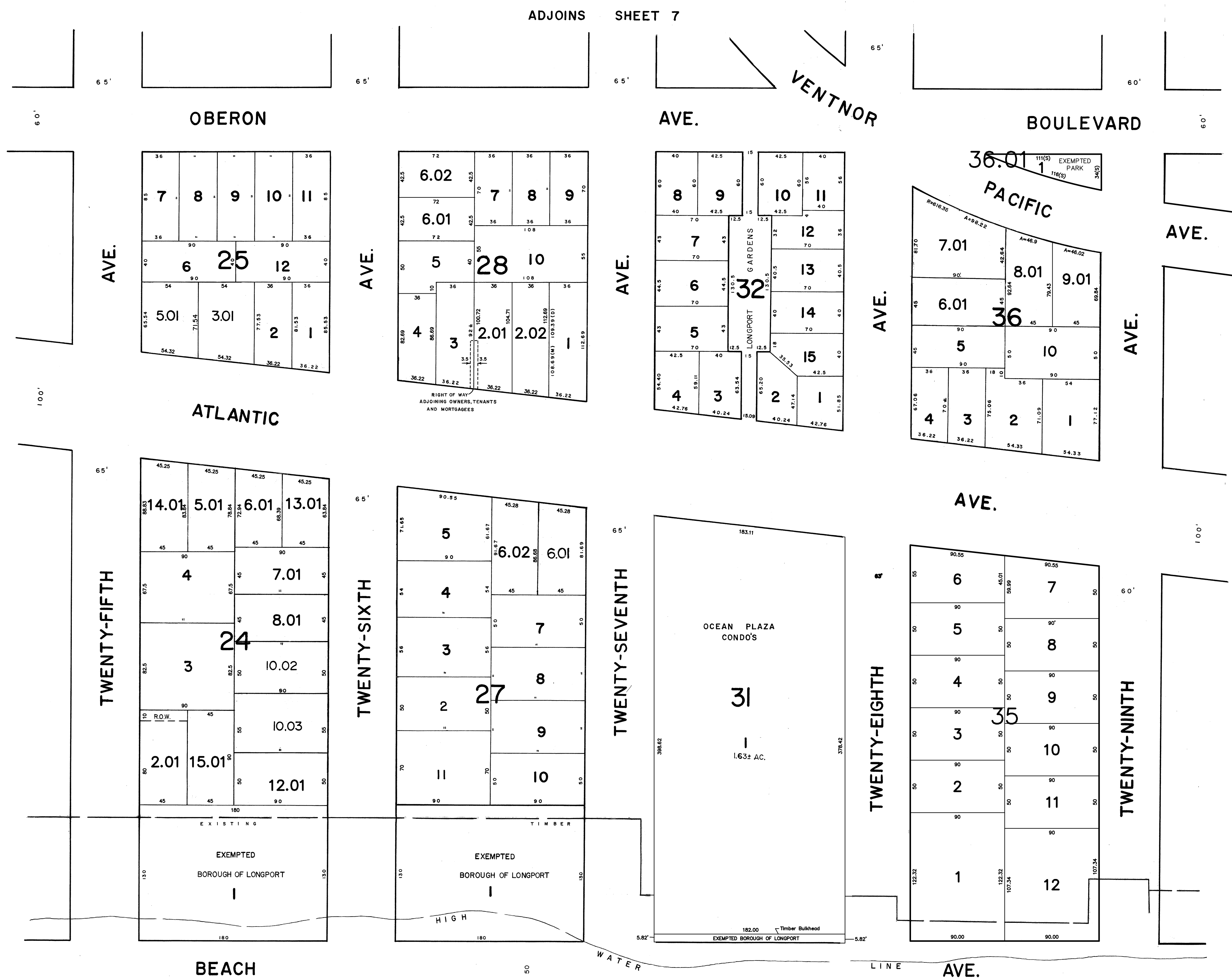

6/2017	BL28	LOTS 6.01 6.02 & BL 36 L 9.01	PER DC
8/2014	BL31/31.01	LOTS 1,1,01 1974 Dead Info	Assessor
5/2005	BLOCK 36	LOTS 8 & 9, PER ASSESSOR	NON
5/2005	BLOCK 28	LOT 2, PER ASSESSOR	NON
5/2001	BLOCK 28	LOTS 4, 5, SUBDIVISION	SEA
5/2001	BLOCK 36.01	LOT 1, PER ASSESSOR	CBA
5/2001	BLOCK 35	MAJOR SUBDIVISION	CBA
7/1/93	BLOCK 24	PER ASSESSOR	CBA
12-1-92	GENERAL - PER N. DEPT. OF TREASURY		CBA
12/26/91	BLOCK 27	PER ASSESSOR	CBA
10-17-90	BLOCK 27	MIN. SUBDIVISION	DECO
DATE	REVISION		BY

ATLANTIC

ELECTRONIC COPY

DANIEL J. PONZIO SR.
 NEW JERSEY LIC. #GS37603
 TO SHOW CONDITIONS AS OF JUNE, 2017

101
31.01
 EXEMPTED BOROUGH OF LONGPORT
 REPARAN

1045.07
 1.01 35.01 12.01
 REPARAN REPARAN REPARAN
 90.00 90.00 90.00

NEW JERSEY DEPARTMENT OF THE TREASURY
 DIVISION OF TAXATION
 PUBLIC UTILITY TAX BUREAU
 APPROVED AS A TAX MAP PURSUANT TO THE
 PROVISIONS OF CHAPTER 175, LAWS OF 1913, ETC.
 FOR THE DIRECTOR, DIVISION OF TAXATION.
 BY *J. H. [Signature]* E.&L.S.
 L.I.C. #5009 STAT. SUPERVISOR
 DATE DEC 8 1970 SERIAL No. 498

TAX MAP
 OF THE
BOROUGH OF LONGPORT
ATLANTIC COUNTY, N.J.
 SCALE: 1" = 50'
 1970
 REV. JAN. 1984
 J. THOMAS WOOD, JR., P.E. & L.S. NO. 8139
 GEORGE E. SCHILLING, L.S. NO. 16198
 421 GUARANTEE TRUST BLDG.
 ATLANTIC CITY, N.J.

DECO 1989 REVISIONS